

Managed Machine Network



JUNE 2020

SIM card

Preparation

MMMN
MANAGED MACHINE NETWORK

Preface

In this document we will be talking about the procedure of how Managed Machine Network administers SIM cards, what to do if you purchase and use your own SIM card followed by an instruction of how to disable a pin-code using a mobile phone with iOS or Android.



SIM card Preparation

If you would like to provide your own SIM card there is a special procedure to ensure that the SIM card works.

1. The SIM card must be activated.
2. The SIM card needs an internet connection. You can check this by inserting the SIM card in your phone, then use an app of your choice which requires internet (like an internet browser). Do not forget to disable your wireless connection.
3. Disable the SIM card's pincode [See page 4 for instructions](#).

Make sure these three steps are done before sending the SIM card to us.

Mind that you will need a nano-SIM card to normal SIM adapter or provide us with a nano-SIM to normal SIM adapter



Disable a pincode

Android phone

Insert the SIM card into your mobile phone and follow these steps below:

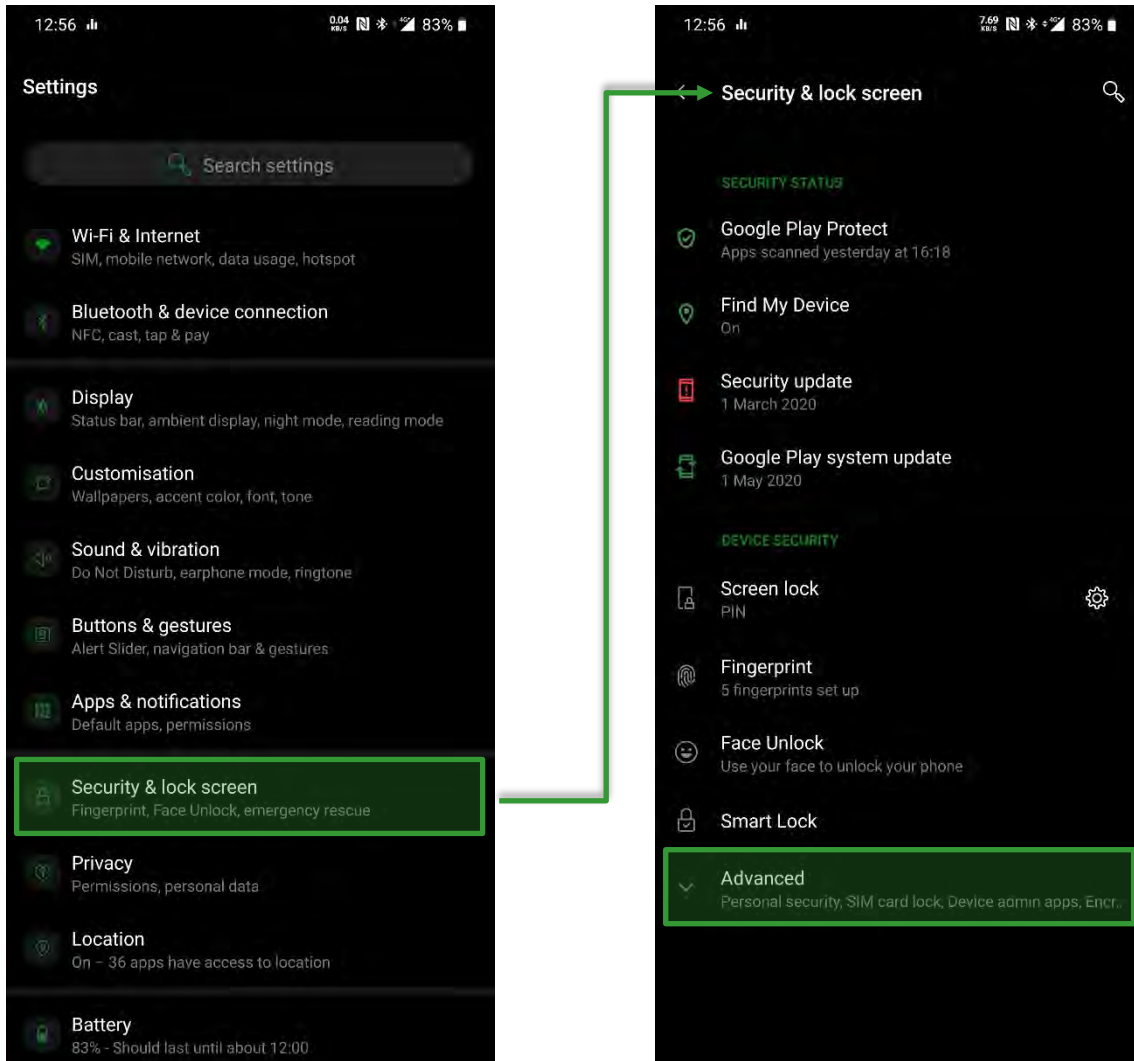

MANAGED MACHINE NETWORK

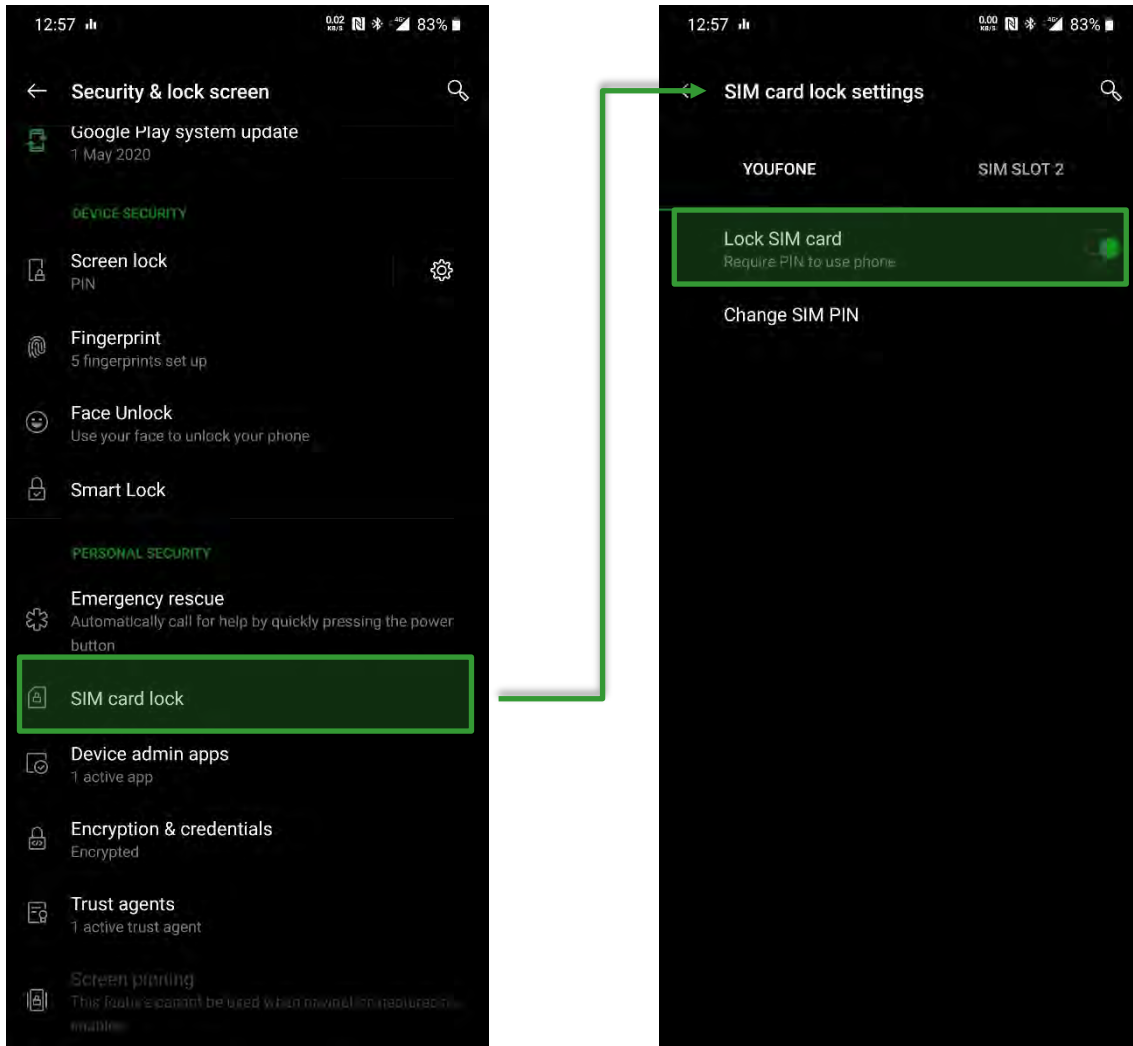

Slide the '**Lock SIM card**' to the left to disable the pincode.

After following these steps, you have successfully disabled the pincode and you may now remove it from its slot.

Apple iPhone (IOS)

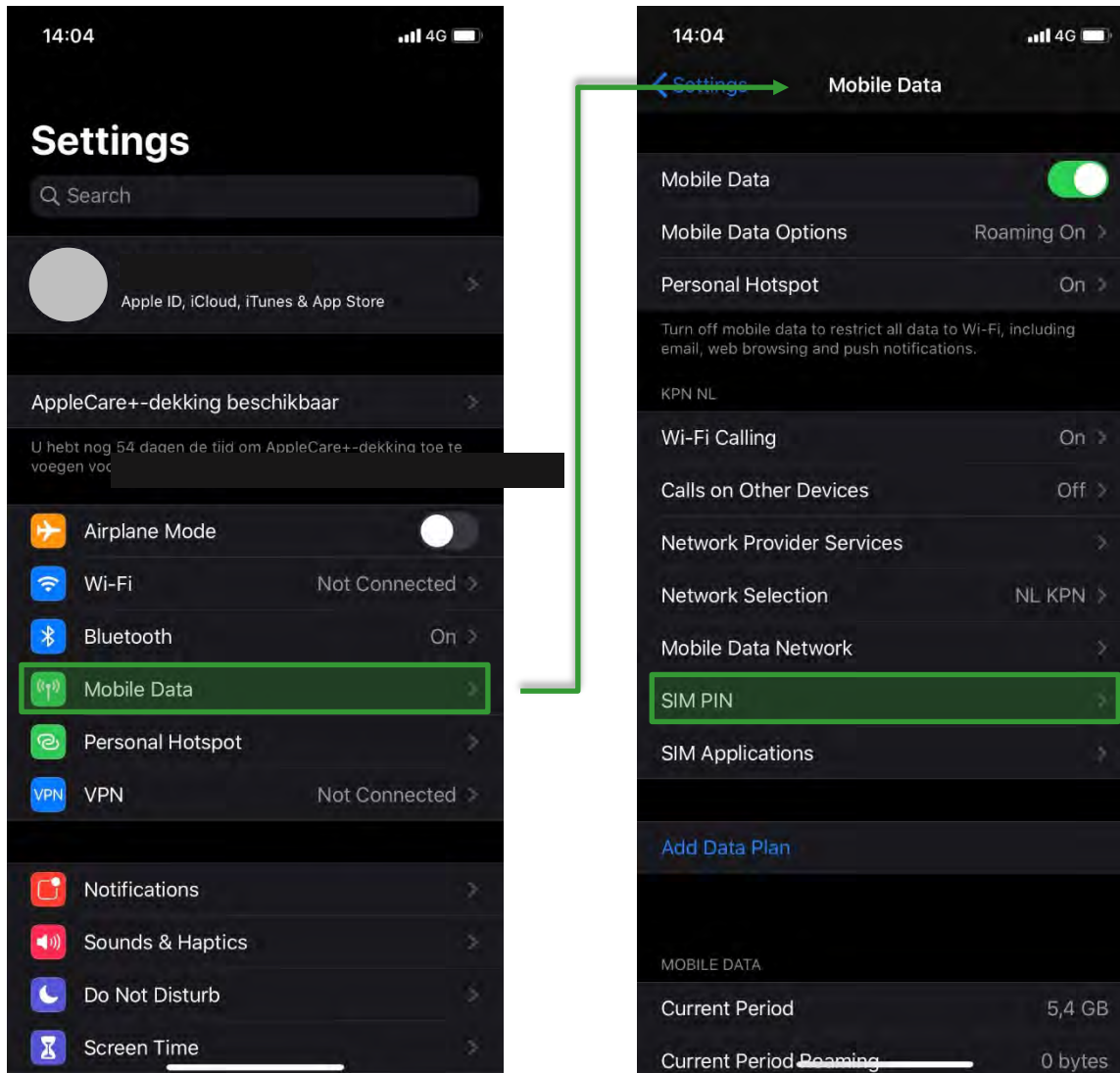

MANAGED MACHINE NETWORK



Slide the '**SIM PIN**' to the left to disable the pincode.

After following these steps, you have successfully disabled the pincode and you may now remove it from its slot.